

ASSEMBLING THE WINE UNITS

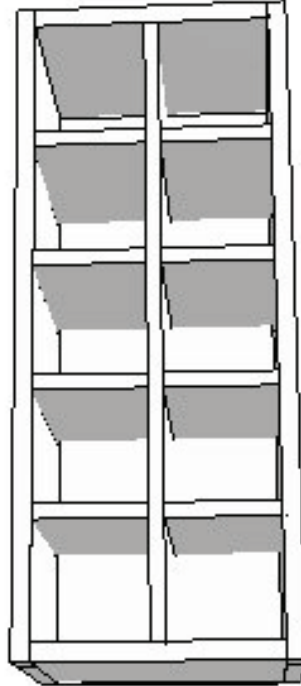

USING THE CAM SYSTEM

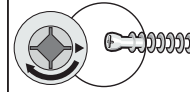

INSERT THE CAM SCREWS INTO THE SIDES SO THAT IT PROTRUDES ENOUGH FOR THE HEAD OF THE SCREW TO BE ROUGHLY CENTRED IN THE CAM HOLES IN THE BASE

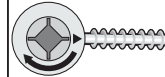

START WITH THE TRIANGLE POINTING TO THE SIDE PIECE

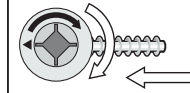

TURN A HALF ROTATION SO THAT THE TRIANGLE POINTS TO THE INSIDE OF THE CABINET

1 PLACE SIDE OVER CAMS ON THE BASE

PLACE BASE(b) FLAT, JOIN SIDE(c) TO THE LEFT OF BASE, TIGHTEN CAMS.

2 PLACE THE BACKING OVER CAMS ON THE BASE

FIT BACKING OVER CAMS ON BASE(b), TIGHTEN CAMS

3 FIT OPPOSITE SIDE TO BASE

FIT SIDE(d) TO THE BACKING AND BASE(b), TIGHTEN CAMS

4 FIT THE TOP(a) INTO PLACE TO CLOSE UP THE UNIT, TIGHTEN THE CAMS

5 SLIDE ALL 3 SHELVES INTO PRE-GROVED SLOTS ON THE INTERNAL SIDE, TIGHTEN CAMS.

6 FIT THE SHELVING INTO THE ALREADY ASSEMBLED CARCASS, TIGHTEN CAMS.