

# ASSEMBLY INSTRUCTIONS

# WALK IN PANTRY

## ASSEMBLING THE WALK IN PANTRY

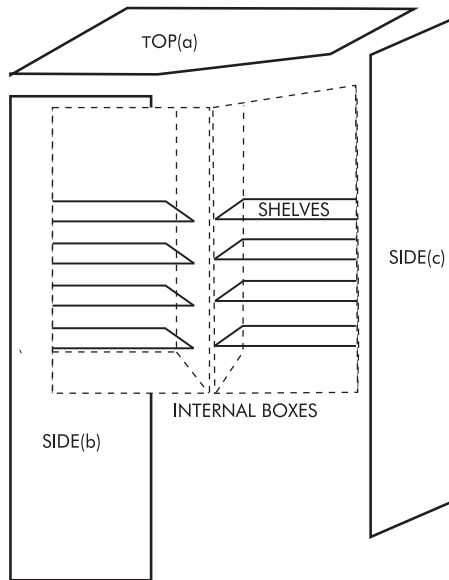

## USING THE CAM SYSTEM

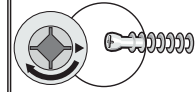

INSERT THE CAM SCREWS INTO THE SIDES SO THAT IT PROTRUDES ENOUGH FOR THE HEAD OF THE SCREW TO BE ROUGHLY CENTRED IN THE CAM HOLES IN THE BASE

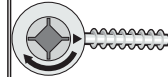

START WITH THE TRIANGLE POINTING TO THE SIDE PIECE

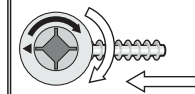

### 1 INTERNAL BOXES

INSERT CAMS AND DOWELS INTO THE PRE-DRILLED HOLES  
JOIN THE BASES TO 1  
SIDE SLIDE MASONITE BACKING INTO PLACE  
PUT LAST SIDE INTO PLACE TO CLOSE UP THE UNIT  
TIGHTEN ALL THE CAMS

### 2 MOUNT THE INTERNAL BOXES TO THE WALLS

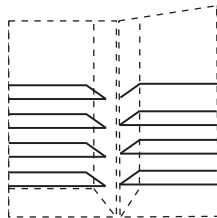

### 3 ATTACH THE ROOF

PLACE THE ROOF ON TOP OF BOXES ENSURING THAT IT IS LEVEL WITH THE SIDES AND SECURE WITH 6X80 SCREWS. (THROUGH THE ROOF INTO THE SIDES OF THE INTERNAL BOXES)

### 4 ATTACH THE SIDES

PLACE THE SIDES AGAINST THE SIDES OF THE ROOF MOUNTED INTERNAL BOXES SECURE WITH 8X30 SCREWS AT THE TOP AND BOTTOM FROM THE INSIDE OF THE INTERNAL BOXES INTO THE SIDE. REPEAT ON THE OTHER SIDE

### 5 SECURING THE PANELS

SECURE THE SIDES AND BOTTOM CORNER OF THE PANTRY TO THE WALL WITH CORNER BRACKETS BOTH SIDES

### 6 MEASURE THE DOOR WAY, THE GAP SHOULD BE 545MM

### 7 INSTALL THE SHELF STUDS INTO PRE-DRILLED HOLES ATTACH DESIRED LEVEL AND INSTALL SHELVES.