

1

ASSEMBLING THE CORNER UNITS

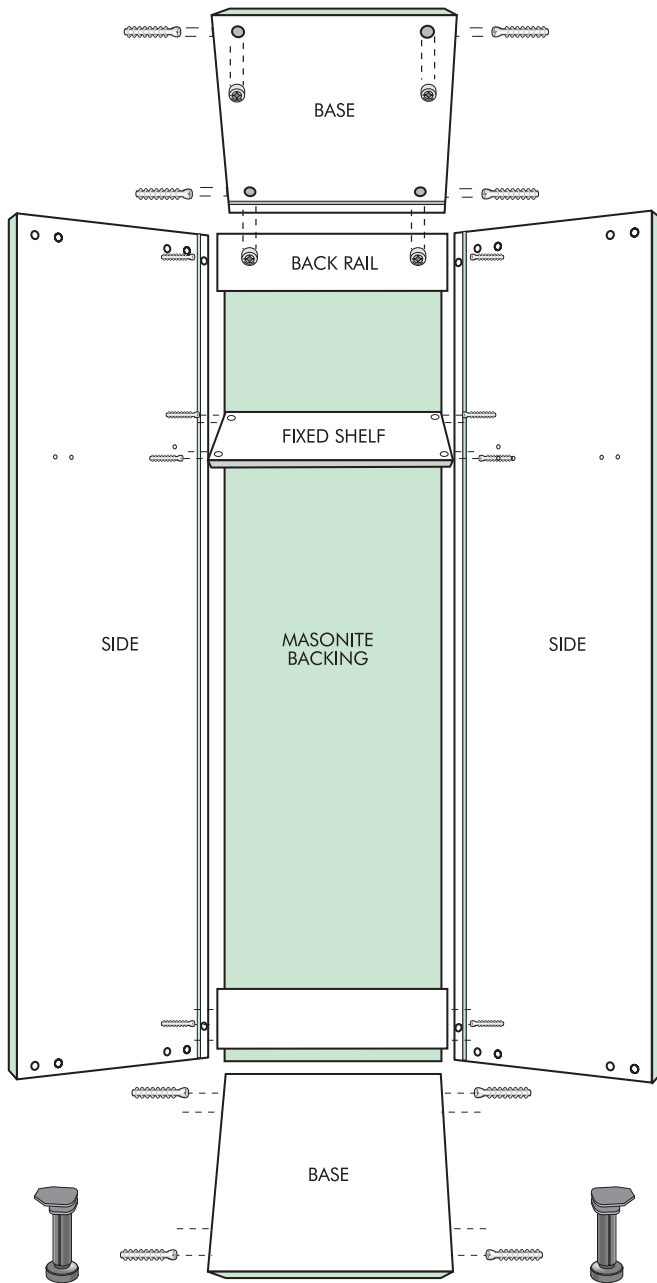

2

ADD THE TOP, BOTTOM, CLEATS + FIXED SHELF TO THE RIGHT SIDE

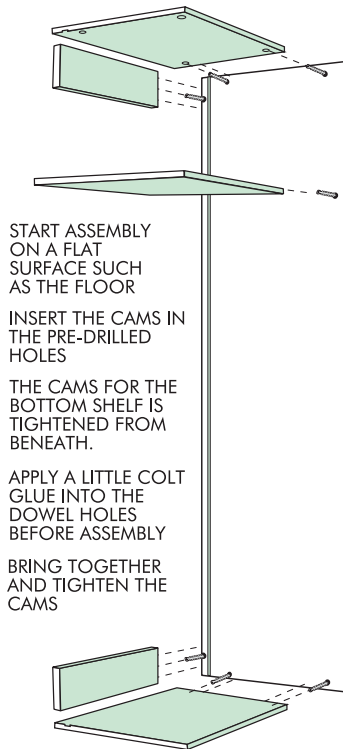

START ASSEMBLY ON A FLAT SURFACE SUCH AS THE FLOOR

INSERT THE CAMS IN THE PRE-DRILLED HOLES

THE CAMS FOR THE BOTTOM SHELF IS TIGHTENED FROM BENEATH.

APPLY A LITTLE COLT GLUE INTO THE DOWEL HOLES BEFORE ASSEMBLY

BRING TOGETHER AND TIGHTEN THE CAMS

3

ADD THE BACKING BOARD

SLIDE THE BACKING BOARD INTO THE GROOVE

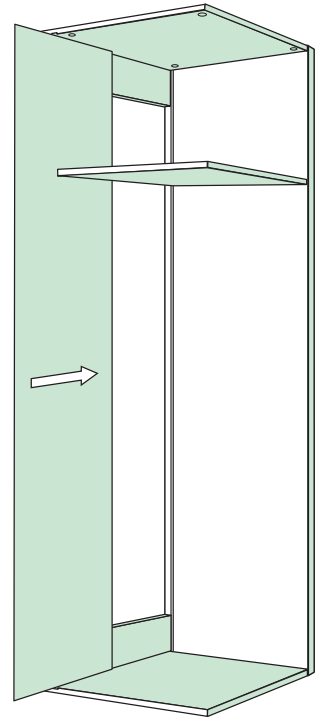

4

ADD THE LEFT SIDE

FIX THE REMAINING SIDE INTO PLACE

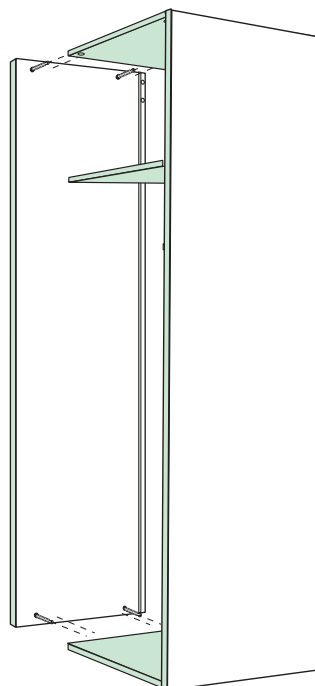

5

ADD THE LEGS

NB USING 8 X 30 SCREWS SECURE THE BACKING

NB USING 8 X 30 SCREWS LOCK THE CAMS FROM THE SIDE OF THE UNIT

TO INSERT THE LEGS THE CABINET IS BEST PLACED ON THE FLOOR. PLACE THE LEGS 16MM AWAY FROM THE EDGE OF THE UNIT WITH THE TABS FACING OUT AND SCREW DOWN. TURN THE CABINET UPRIGHT AGAIN

USING THE CAM SYSTEM



INSERT THE CAM SCREW INTO THE SIDES TO THAT IT PROTRUDES ENOUGH FOR THE HEAD OF THE SCREW TO BE ROUGHLY CENTRED IN THE CAM WHOLES IN THE BASE

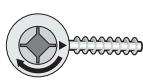

START WITH THE TRIANGLE POINTING TO THE SIDE PIECES

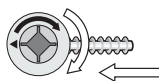

TURN A HALF ROTATION SO THAT THE TRIANGLE POINTS TO THE INSIDE OF THE CABINET