



- 10** Using 8X16 screws fasten metal brackets to BIC sides (flush with wall). Before securing to the wall, ensure the cupboard is correctly plumbed by using a level. Fasten metal brackets to the wall using hammer plugs.



# ASSEMBLY INSTRUCTIONS BIC



## CHECKLIST: BIC 1220

- A = 3X BASE / FIXED SHELF (1184X500)
- B = 3X SHELF ADJUSTABLE (584X490)
- C = 2X SIDE EXTERNAL (2100X500)
- D = 1X SIDE INTERNAL (1427X500)
- F = 2X KICK PLATE (1184X160)
- G = 2X DOOR (1933X593)

- 1X HANGING RAIL
- 2X HANGING RAIL BRACKET
- 6X HINGE
- 6X HINGE PLATE
- 16X KITCHEN KD
- 4X METAL BRACKETS (45X45)
- 4X PANEL PINS (40MM)
- 6X SCREWS 8X30
- 20X SCREWS 8X16
- 4X HAMMER PLUGS
- 12X SHELF STUD
- 32X WOODEN DOWELS 8X30

## YOU WILL NEED:

- A hammer
- Wood glue
- Star screw driver
- Power Drill
- Level
- Tape Measure
- Pencil



## CHECKLIST: BIC 1520

- A = 3X BASE / FIXED SHELF (1484X500)
- B = 3X SHELF ADJUSTABLE (484X490)
- C = 2X SIDE EXTERNAL (2100X500)
- D = 1X SIDE INTERNAL (1427X500)
- E = 1X SIDE INTERNAL (465X500)
- F = 2X KICK PLATE (1484X160)
- G = 3X DOOR (1933X493)

- 1X HANGING RAIL
- 2X HANGING RAIL BRACKET
- 9X HINGE
- 9X HINGE PLATE
- 16X KITCHEN KD
- 6X METAL BRACKETS (45X45)
- 4X PANEL PINS (40MM)
- 26X SCREWS (8X16)
- 6X SCREWS (8X30)
- 6X HAMMER PLUGS
- 12X SHELF STUD
- 32X WOODEN DOWELS (8X30)

**Note:** Assembly instructions are applicable to all BIC sizes.

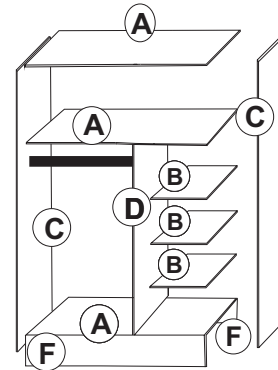

### Standard Components

- A = Base/Fixed shelf
- B = Shelf Adjustable
- C = External side
- D = Internal side
- E = Internal side
- F = Kick Plate
- G = Doors

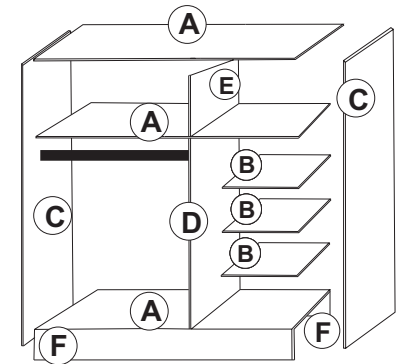

- 11** Attach the base plates to the hinges and hammer them into the correct holes on the door. Place the door upright and fasten the door to the side of the BIC.

**Note:** The hinges have adjustment screws to ensure the correct alignment of the door.



## Shelves A



## Rail B



## Handles C

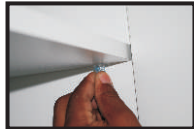

- 12** Install shelves, rail and handles.

**A)** Using shelf studs install adjustable shelves

**B)** To install the rail use a tape measure for accuracy: 100mm below fixed shelf & 250mm from back of cupboard

**C)** To install handles use a tape measure for accuracy: 1100mm from floor & 40mm from door edge

- 1** Check all components and hardware. Place on a large work area (floor). Study the holes on the boards.



**Note:** Place a blanket and news papers/card board on the working area to protect the boards

**WELL DONE!**

- 2** Using a hammer, insert the dowels in the correct holes.



**Note:** you can place a small amount of wood glue in the holes for extra strength



- 3** Using a star screwdriver, insert the KD screws in the correct holes.

- 4** Place all the KD cams into the correct holes.

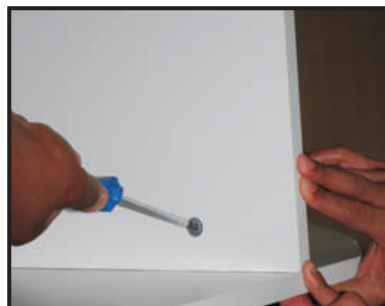

- 5** Starting on the one side of the BIC connect the shelves by fastening the KD screws into the KD cams and dowels into the corresponding holes. Work through to the other side of BIC.



**Note:** To make things easier get someone to assist you

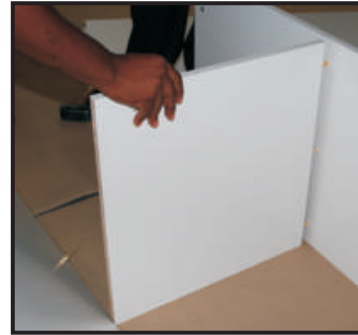

- 6** Don't forget the internal sides. Joins must be flush on the front. Ensure all KD and dowel holes line up.



**Note:** you can place a small amount of wood glue in the holes for extra strength

- 7** Place the first of the end panels into position. Line up the KD screws and holes and secure into position.



- 8** Fit the kick plate.

- 9** Once the cupboard has been completely and correctly assembled on the floor, lift it upright (with some assistance) and place in position flush against the wall where it is to be fastened.



**Note:** To make things easier get someone to assist you

